



# APPLICATION NOTE

## APP #128

### Revision History

Date	Author	Description
07-27-17	DEW	Setup

## REPLACING THE MCS-8-KEYPAD

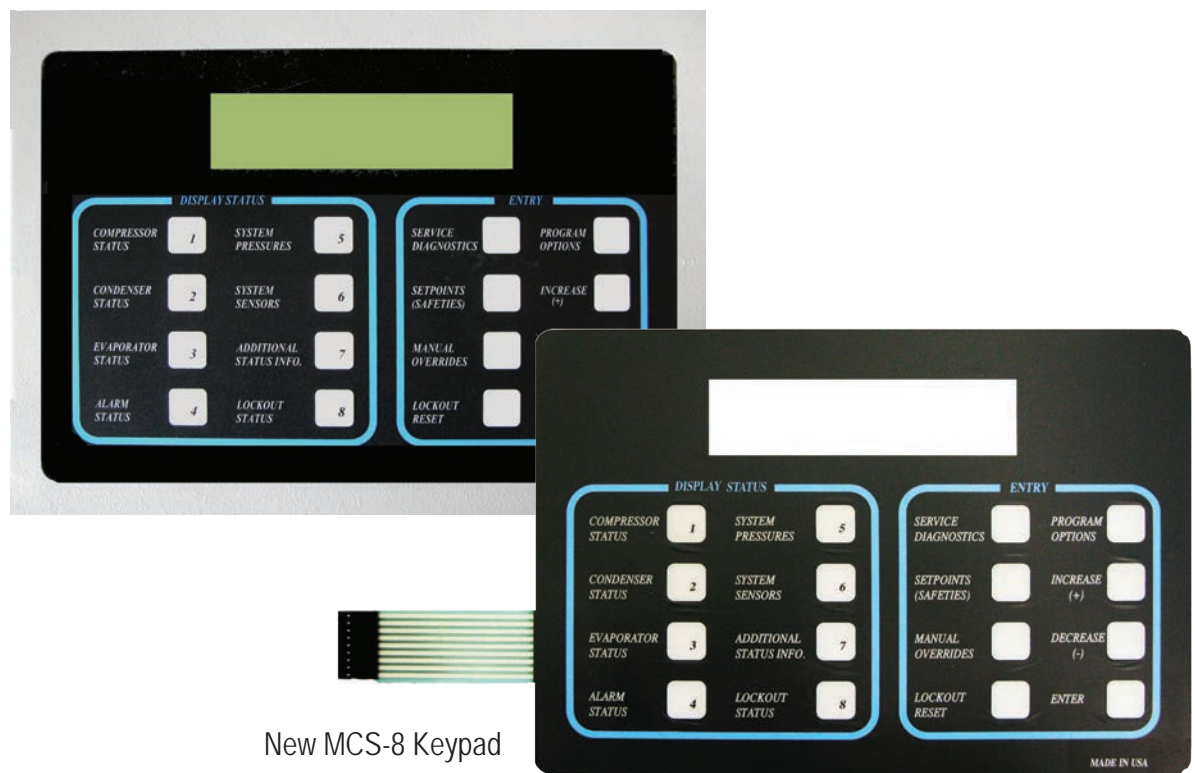

Any questions regarding this release, contact: [support@mcscontrols.com](mailto:support@mcscontrols.com)

Micro Control Systems, Inc. 5580 Enterprise Parkway Fort Myers, Florida 33905  
(239)694-0089 FAX: (239)694-0031 [www.mcscontrols.com](http://www.mcscontrols.com)

Information contained in this document has been prepared by Micro Control Systems, Inc. and is copyright © protected 2017.  
Copying or distributing this document is prohibited unless expressly approved by MCS.

Below, please find instructions on changing the MCS-8-KEYPAD.



## Remove power from the MCS-8 unit.

1. Removing the old keypad, start by removing the ribbon ('**GRAY with red stripe**') and than the '**GREEN keypad ribbon**' from the MCS-8 board.

Remove the door keypad from the MCS-8 enclosure by unscrewing the two thumb screws holding the door to the enclosure.

2. Using a small thin screw driver insert at one end of the old black keypad cover and pry up the old keypad from the gray door cover.

Remove old keypad completely from the front of the door.

Lay the new MCS-8 KEYPAD on a flat surface, face down

3. Remove the small 3M backing from the back around the keypad ribbon first.
4. Peel back the 3M backing about 1" at the edge of the keypad where you just removed the backing in step 3.

Thread the ribbon through the hole provided for in the enclosure door.

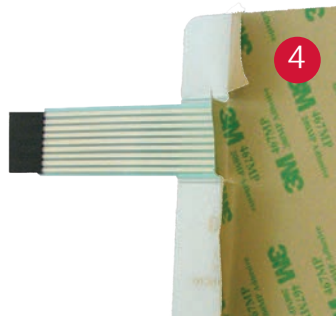

5. Lay the new keypad on the front of the door enclosure starting at the ribbon edge.
6. Press the leading edge down firmly to hold in place.
7. Peel all the 3M backing from the back of the new keypad and drop onto the enclosure ensuring that the keypad goes on straight.
8. Press the Keypad in place, pulling on the keypad ribbon so it is flat on the inside of the door, now press firmly on the keypad.
9. **Remove the clear plastic protector from the front of the new keypad.**
10. Refasten the cover to the enclosure using the two thumb screws.
11. Plug in the keypad ribbon and the power ribbon to the ports on the MCS-8 as shown in figure 1.

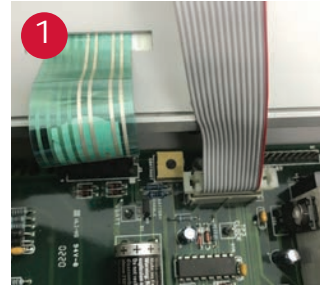

New MCS-8 Keypad mounted on door enclosure